

## Yoke Grade 8 Bolt-on Lifting Point BS EN 1677-1+2

- Designed with spring, stop at any angle supplied without bolt
- Pivots 180° and allows side load lifting.
- Manufactured from forged alloy steel, quenched and tempered.
- Manufactured and tested in accordance with EN1677-1.
- Load rated parts are 100% magnaflux crack detected.
- Individual forged parts are traceable to Test Certification.
- Supplied without bolts; usage of Grade 10.9 or Grade 12.9 bolts is recommended.
- Proof tested to 2.5 times the WLL.
- Fatigue rated to 1.5 times the WLL.
- Design Factor 5 : 1
- All YOKE lifting points meet or exceed all the requirements of ASME B30.26.

### USES

- Designed to be semi-permanent lashing or lifting point
- Suitable for attachment to lifting beams and spreader beams

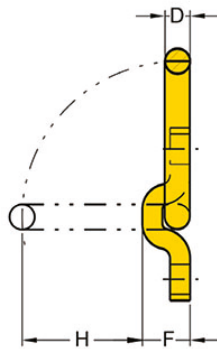
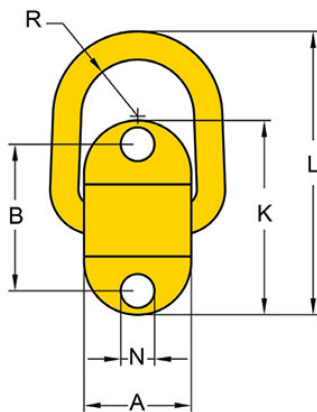

### METRIC SPECIFICATIONS

| Part Code | WLL tonnes | A mm | B mm | D mm | F mm | H mm | K mm | L mm | N mm | R mm | Mass Kg |
|-----------|------------|------|------|------|------|------|------|------|------|------|---------|
| 8-058-1T  | 1.0        | 50   | 72   | 14   | 27   | 55   | 98   | 139  | 14   | 24   | 0.7     |
| 8-058-3T  | 3.0        | 58   | 84   | 17   | 33   | 50   | 114  | 144  | 18   | 29   | 1.1     |
| 8-058-5T  | 5.0        | 64   | 116  | 22   | 43   | 74   | 160  | 203  | 23   | 33   | 2.5     |

### IMPERIAL SPECIFICATIONS

| Part Code | WLL lbs. | A inch | B inch | D inch | F inch | H inch | K inch | L inch | N inch | R inch | Mass lbs. |
|-----------|----------|--------|--------|--------|--------|--------|--------|--------|--------|--------|-----------|
| 8-058-1T  | 2200     | 1.97   | 2.83   | 0.55   | 1.06   | 2.17   | 3.86   | 5.47   | 0.55   | 0.94   | 1.5       |
| 8-058-3T  | 6600     | 2.28   | 3.31   | 0.67   | 1.30   | 1.97   | 4.49   | 5.67   | 0.71   | 1.14   | 2.4       |
| 8-058-5T  | 11000    | 2.52   | 4.57   | 0.87   | 1.69   | 2.91   | 6.30   | 7.99   | 0.91   | 1.30   | 5.5       |

Click here to view video of Yoke Load Attachment Products

<http://www.yoke.net/video/en.asp>

**GPS LIFTING**

18 CHURCH STREET, ASHTON-UNDER-LYNE, LANCASHIRE OL6 6XE